

Zips

Audio Recoiler

ZB2012-B/W & ZB2015-B/W

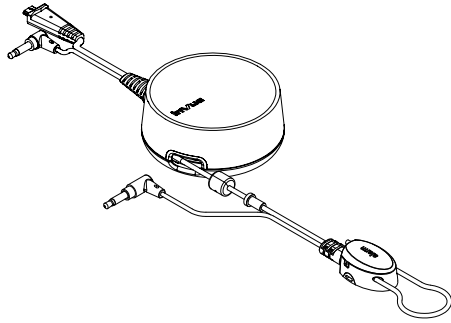

Note: If mounting the recoiler unit below the counter, please see the instructions for the bracket plate (ZR4000).

1 Clean the surface, where the recoiler unit will be mounted, with the provided alcohol wipe. Let it dry completely.

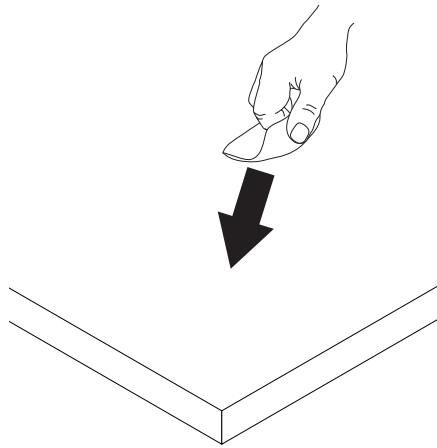

2 Remove the clear film from the adhesives on the bottom of the recoiler unit.

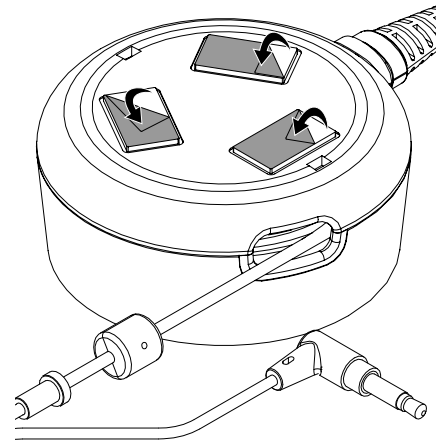

3 Place the recoiler in the desired location and apply pressure for at least 10 seconds.

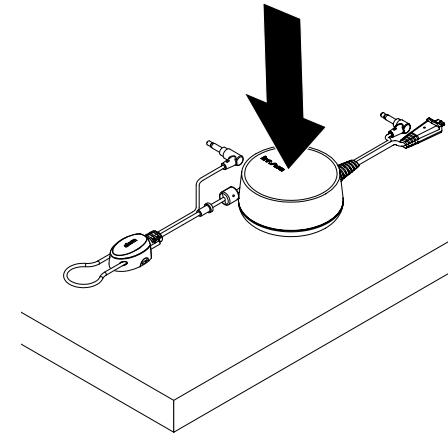

4 Use the provided alcohol wipe to clean the area on the headphone band where the sensor will be placed. Allow it to dry completely.

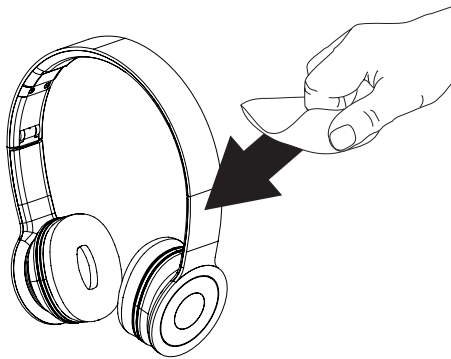

5 Swing the door on the sensor open. Use a TT20 bit to loosen the screw.

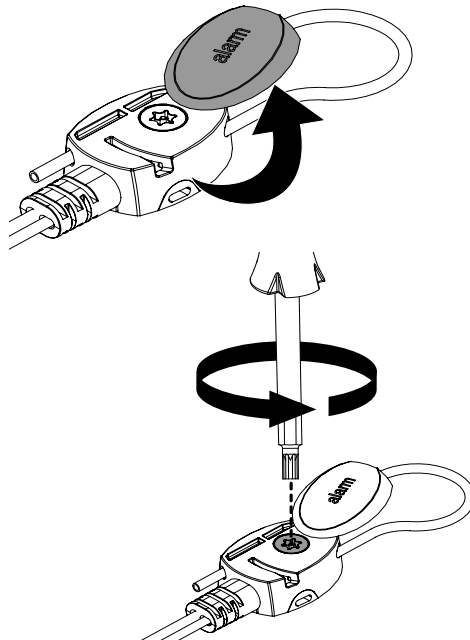

6 Pull the loose end of the tether free from the sensor.

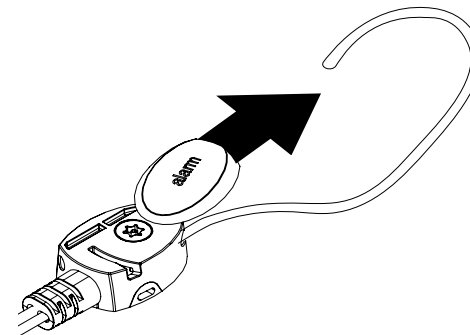

7 Peel the clear film from the adhesive on the sensor.

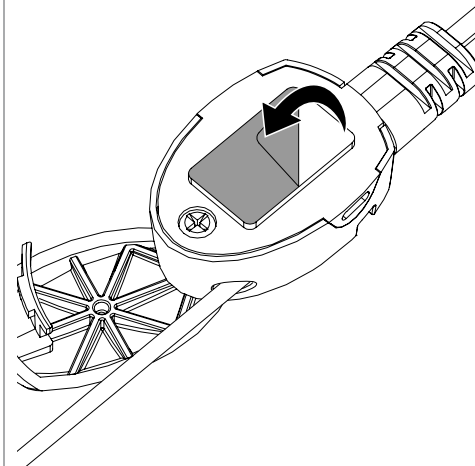

8 Place the sensor onto the headphone band. Apply pressure for at least 10 seconds

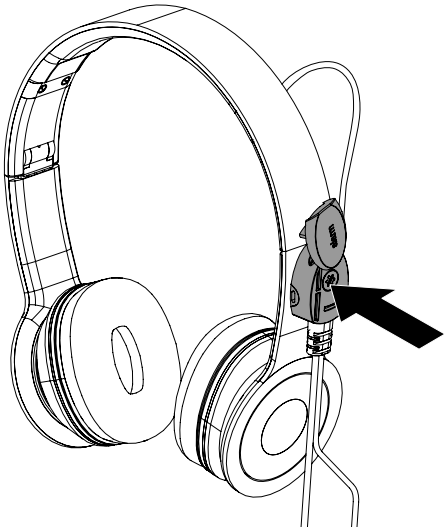

9 Loop the tether around the band, re-insert it into the sensor and pull tight.

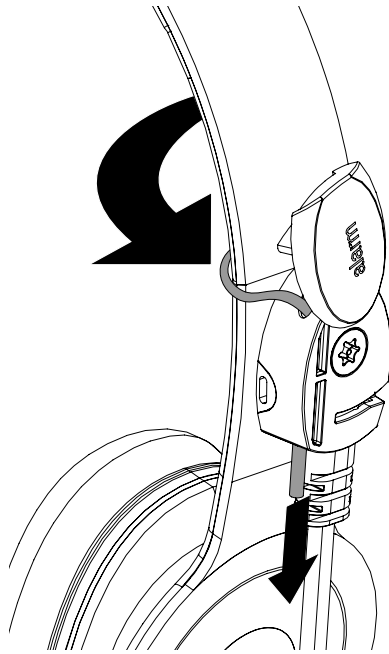

10 Tighten the screw to secure the tether.

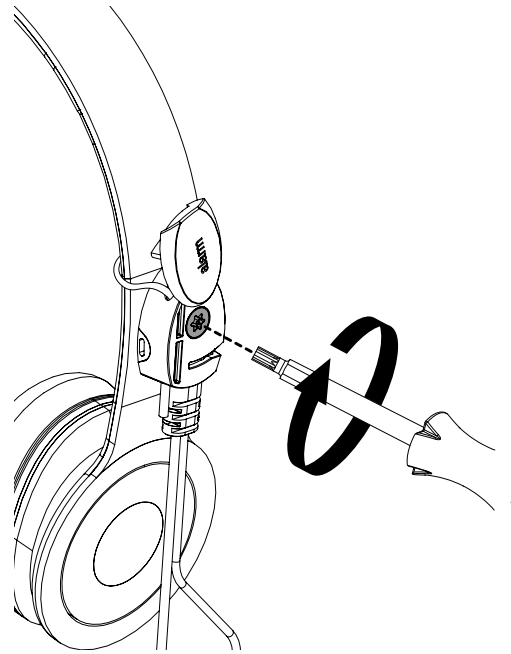

11 Close the door on the sensor.

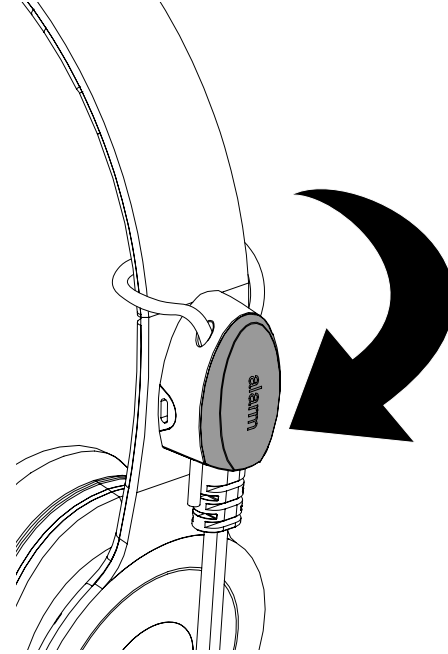

12 Plug the audio jack into the port on the headphones.
Note: Depending on your headphone model, the audio jack can be rotated into the locking position.

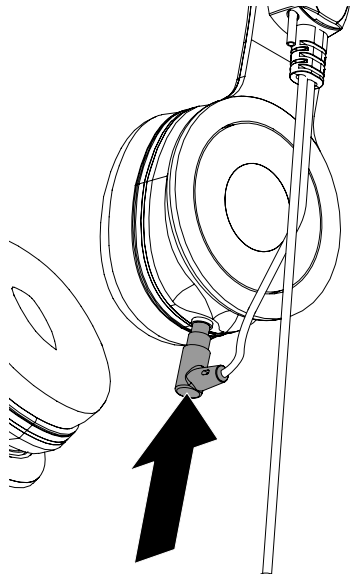

13 Plug the other audio jack into the audio source.

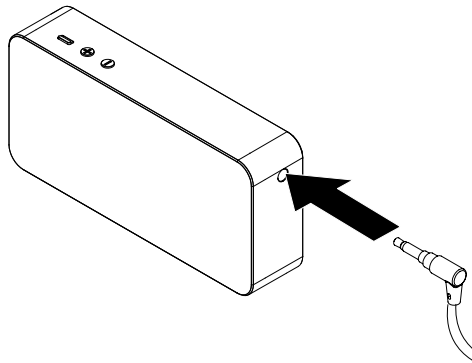

14 Plug the micro USB connector into a previously installed S1060, S1560, S960 Stand, Zips 2.0, Zips 3.0, Zips Power Alarm Unit or S2865 Power Box.

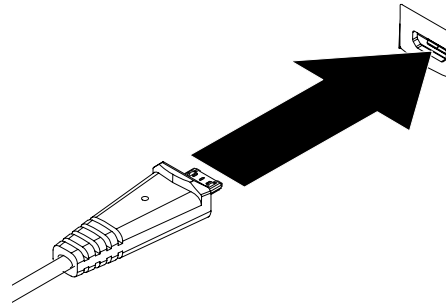

SD0621 Rev2 12/12/19



SABEL

1300 551 662
info@sabel.com.au