

# INVUE

## W2000

Custom Stand - ZW2100-W

Custom Cradle - ZW1974-W

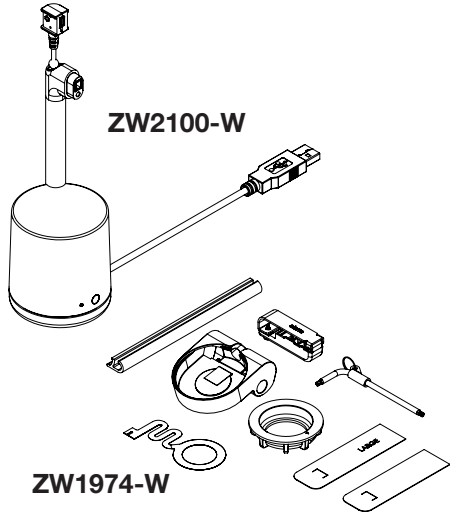

- 1** Use the provided alcohol wipe to clean the fixture where the stand will be placed. Allow it to dry completely.

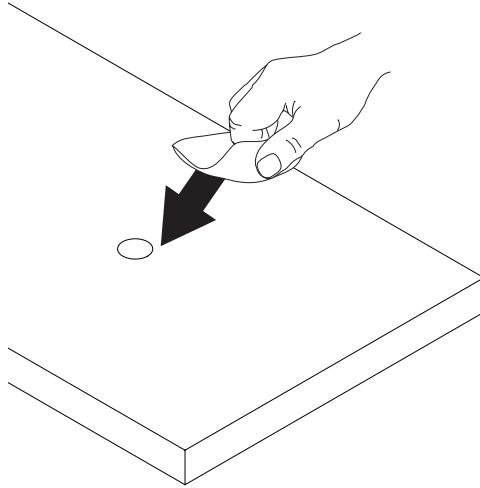

- 2** Place the OEM charger cradle onto the stand.

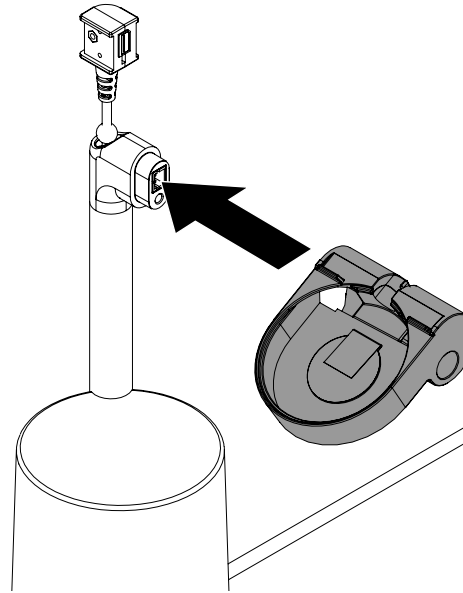

- 3** Insert the provided screw into the hole on the side of the cradle.

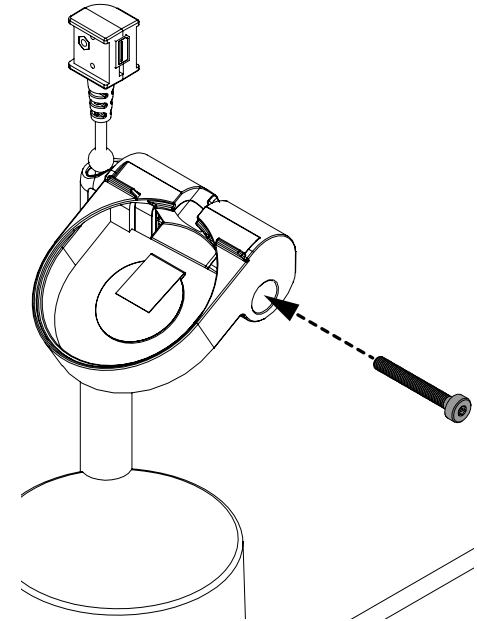

- 4** Use the provided wrench to fully tighten the screw.

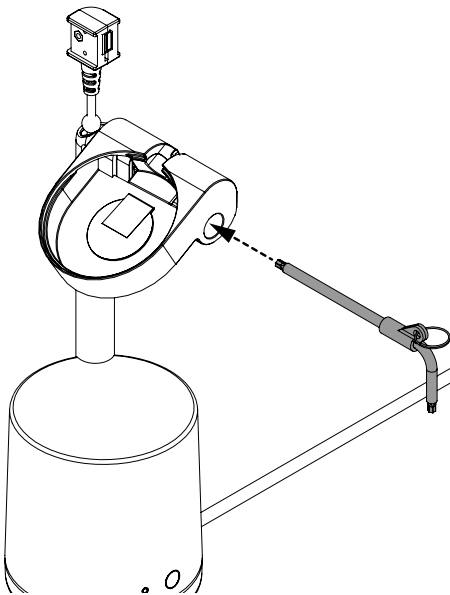

- 5** Insert the OEM charger cable through the center of the cradle insert.

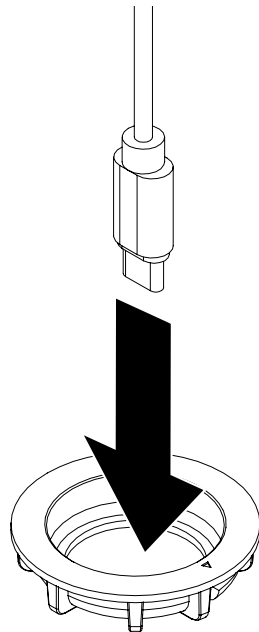

- 6a** Place the charger into the cradle insert.

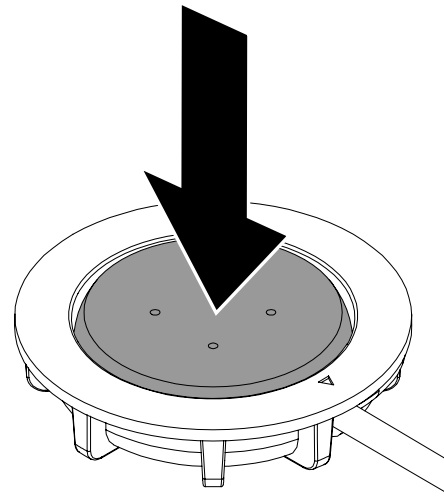

- 6b** Ensure that the cable exits from the side of the cradle and routes around to the back.

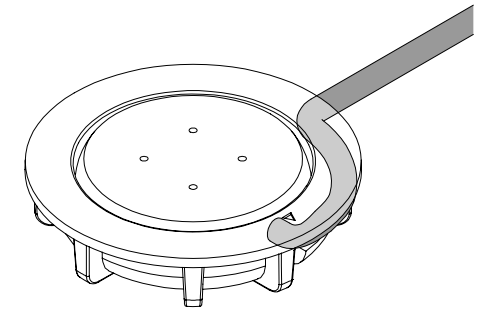

**7** Use an alcohol wipe to clean the bottom of the charger. Allow it to dry completely.

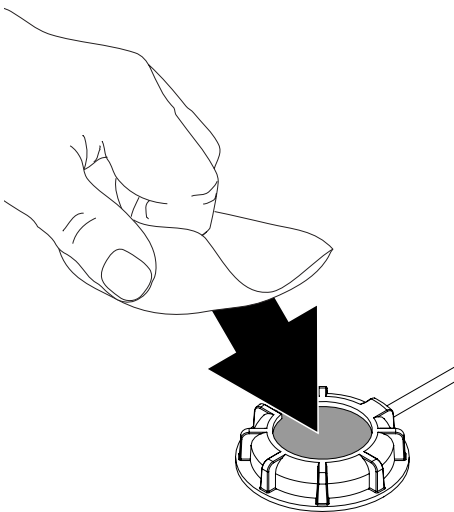

**8** Pull the red tab from the adhesive in the charger cradle.

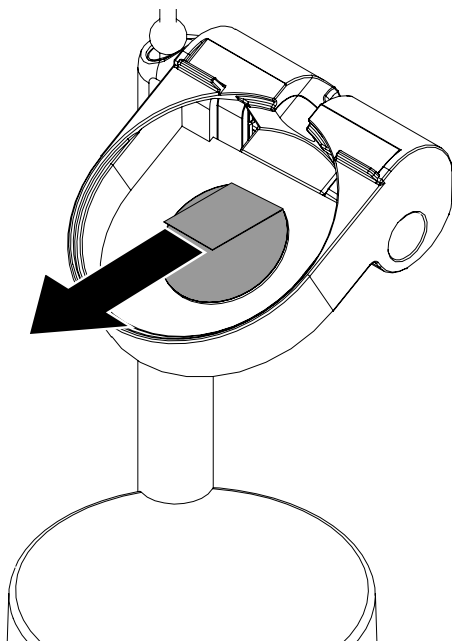

**9a** With the triangle symbol on the cradle insert pointing to the right, place the OEM charger and cradle insert into the cradle. Ensure that the cable is still routed as shown in Step 6b.

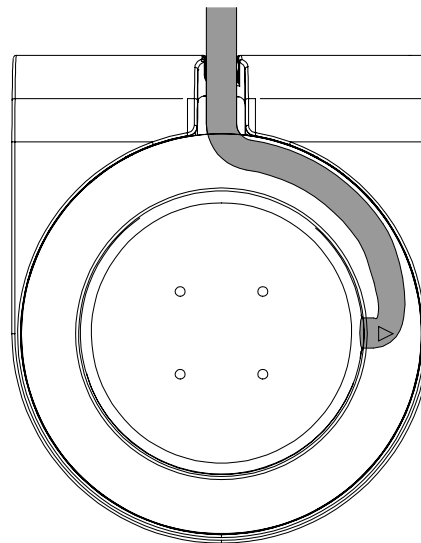

**9b** Press the charger against the adhesive for at least 10 seconds. Ensure that the charger sits flat in the cradle.

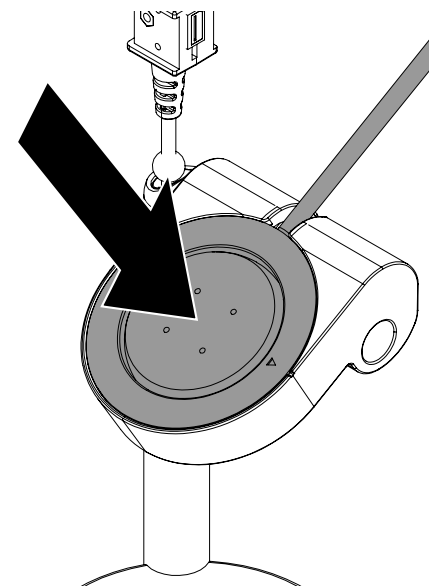

**10** Use the provided alcohol wipe to clean the stem. Allow it to dry completely.

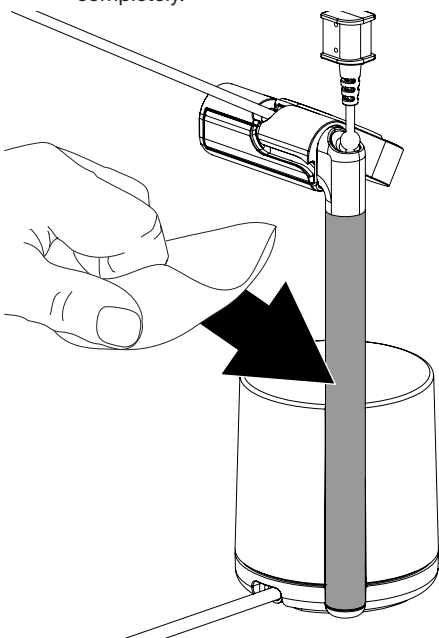

**11** Route the OEM charger cable into the cable guide.

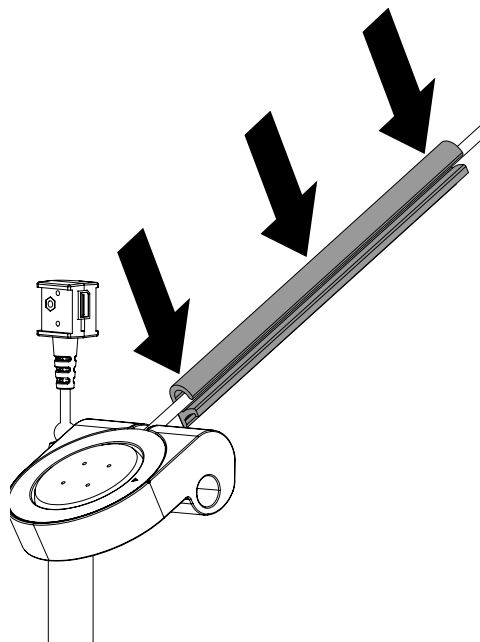

**12** Peel the clear film from the 2 adhesives on the cable guide.

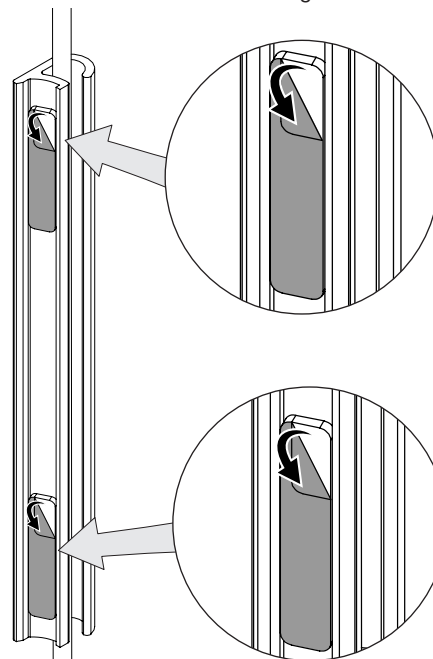

**13a** Align the bottom of the trim piece with the split line on the stand. Press the piece against the back of the stem for at least 10 seconds.

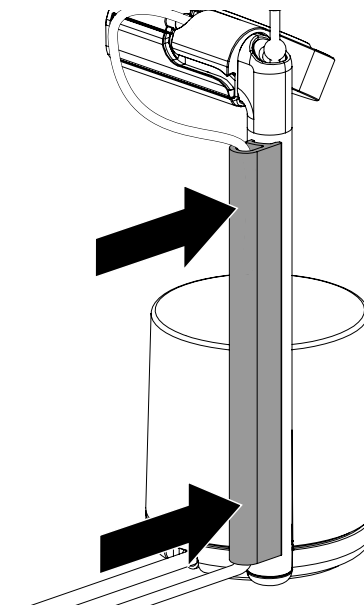

- 13b Ensure that the trim piece is installed in line with the back of the stem as shown.

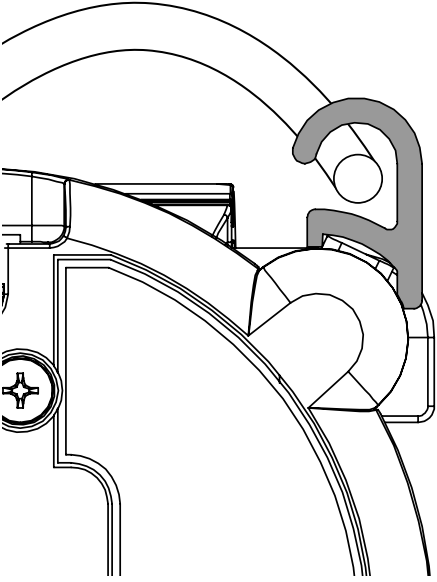

- 14 Route the cable along the track in the back of the cradle. Adjust the cable in the cable guide as necessary.

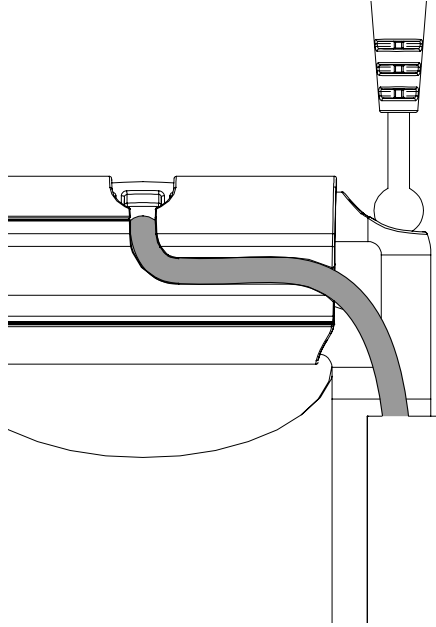

- 15 Peel the clear film from the adhesive on the bottom of the stand.

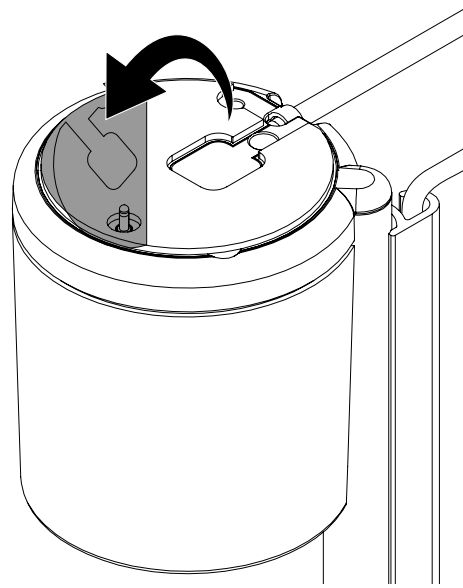

- 16 **Optional:** Route the power cable and OEM charger cable through a hole or slot in the fixture.

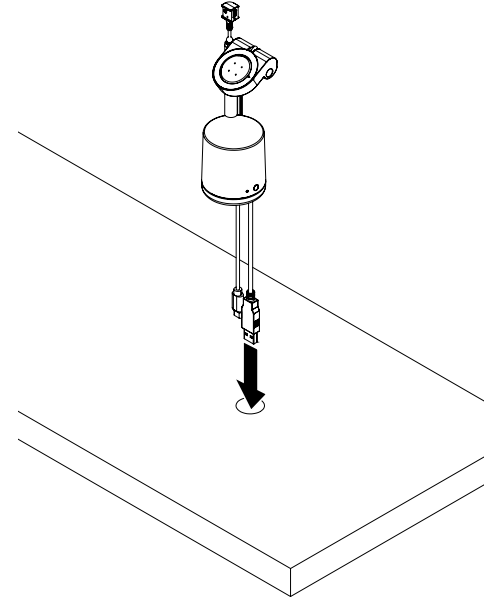

- 17 Place the stand in the desired location and apply pressure for at least 10 seconds.

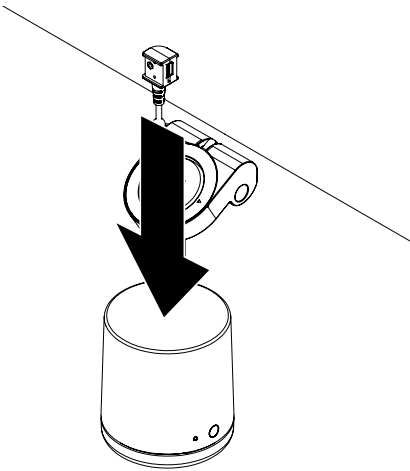

- 18 Lift the connector from the stand, pulling enough cable to aid in the installation of the sensor. Snap the included cable stop clip around the cable to prevent it from retracting.

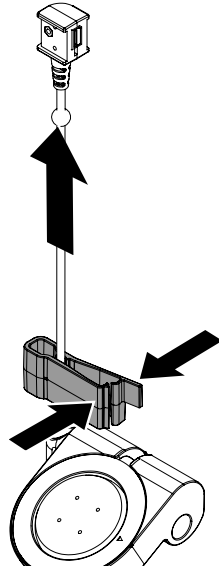

- 19 Open the band clamp and hook it around the end of the connector. Ensure that the screw holes align.

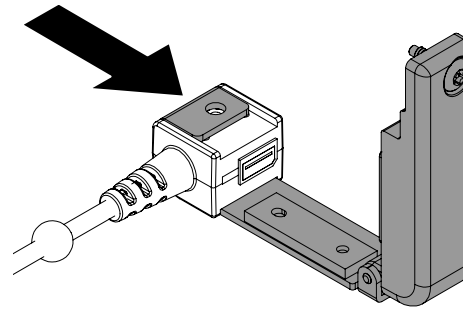

- 20 Select the template that corresponds with the size of the device being installed.

**Note:** Only the template for the Large device is labelled.

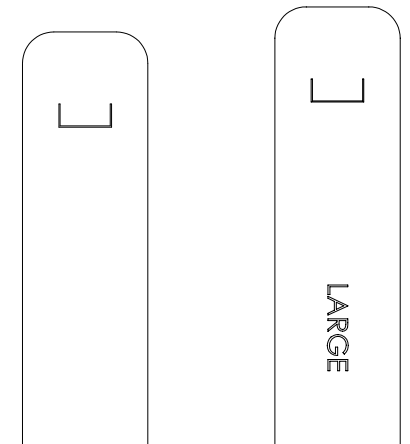

**21** Insert the metal clasp on the watch band through the cut-out on the supplied template.

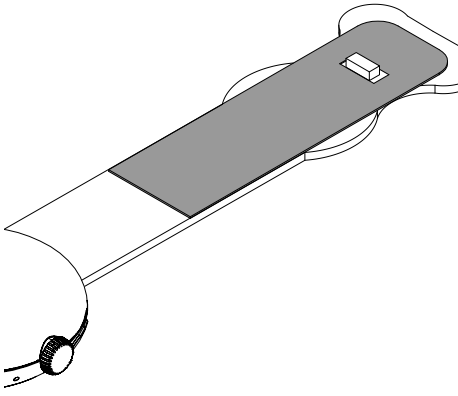

**22** Align the band clamp with the bottom of the template. The “alarm” stamp on the clamp should be facing in the same direction as the watch face.

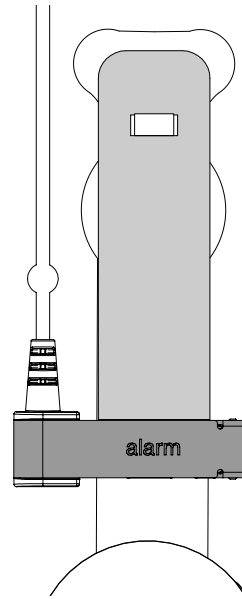

**23** Plug the universal flex sensor into the port on the inside of the band clamp over the wearable.

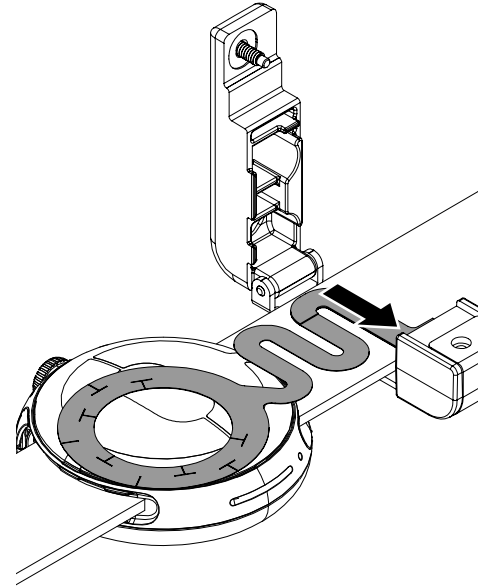

**24** Peel the liner from the adhesive portion of the flex sensor.

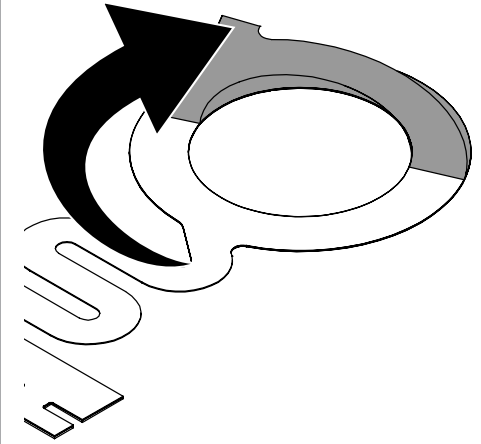

**25** Ensure that the flex sensor is centered on the bottom of the wearable and press the flex adhesive against the wearable for at least 10 seconds. Ensure that all of the circle is adhered to the wearable and that no gap is visible.

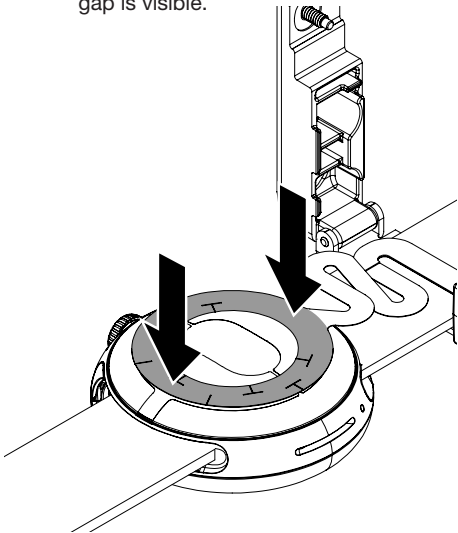

**26** Flip the watch over to access the screw. Close the band clamp over the watch band so that the screw engages with the screw hole.

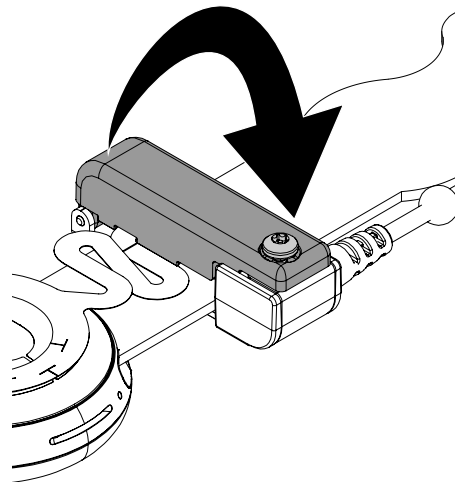

**27** Use the provided wrench to tighten the screw.

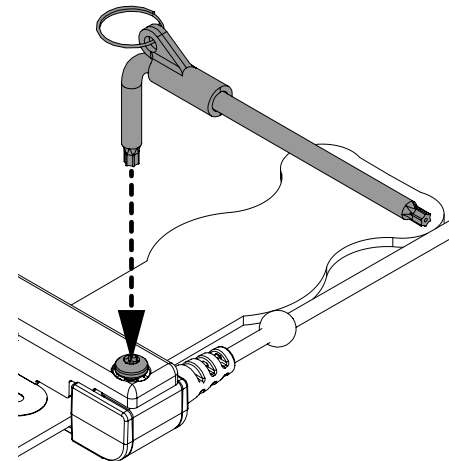

**28** Remove the template from the watch band.

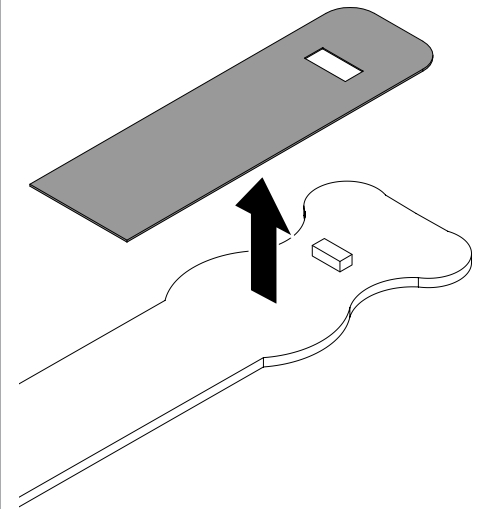

- 29** Unsnap the cable holder from the cable and remove to allow the cable to recoil back into the stand.

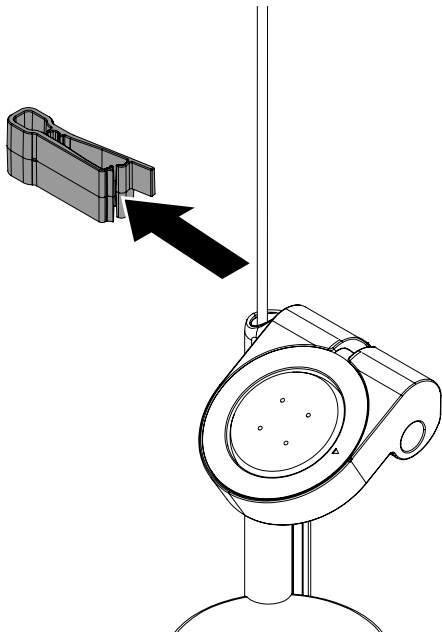

- 30** Place the watch onto the charger and cradle.

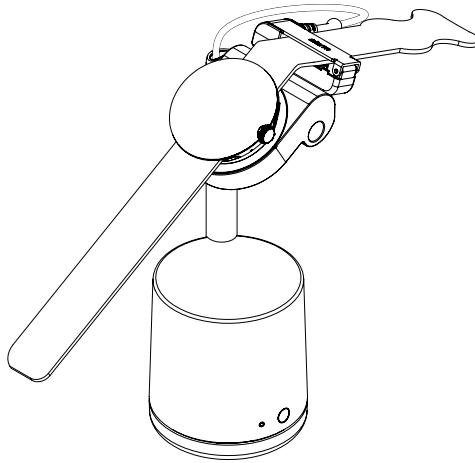

- 31** Plug the OEM charger cable into the OEM charger. Plug the charger into a power outlet.

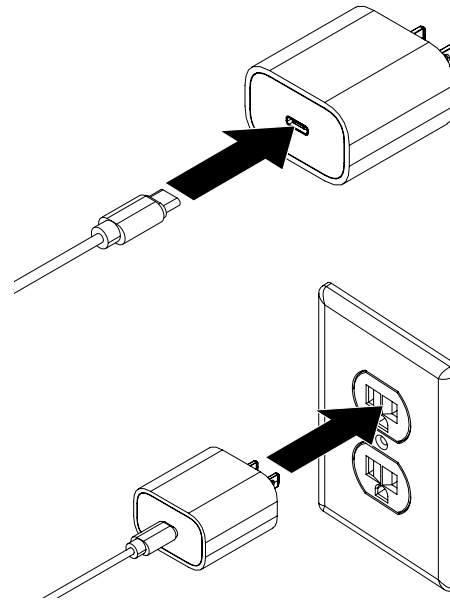

- 32** Plug the stand's power cable into a PS15 power supply. Plug the power supply into a power outlet.

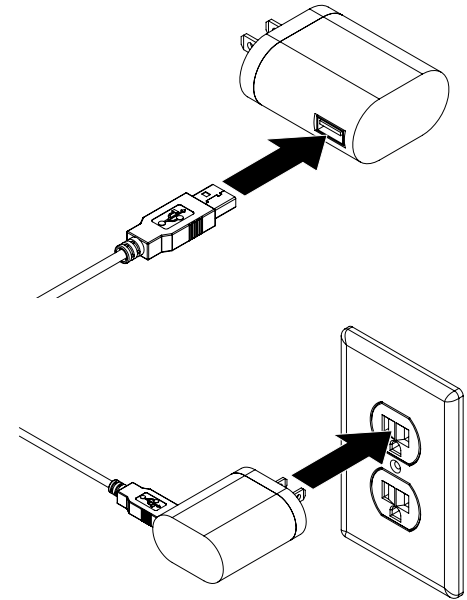

- 33** Place a charged and coded OneKEY against the lens on the side of the stand. Press the button on the key to transfer the code to the stand. This method is also used to deactivate the alarm.

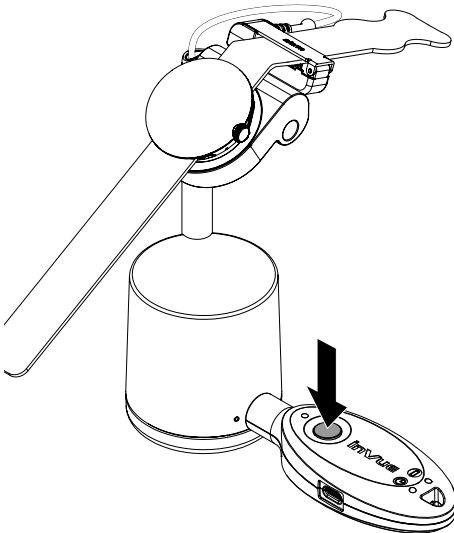

SD0922 Rev1 06/04/24

**INVUE**

[www.invue.com](http://www.invue.com)

NA / LATAM // 704.752.6513 • 888.55.INVUE

EMEA // +31.23.7113377

APAC // +852.3127.6811

© 2024 InVue Security Products Inc. All rights reserved.  
InVue is a registered trademark of InVue Security Products.