

Zips 3.0

Powered Micro-USB, Powered USB-C, Powered Mini-USB & Non-Powered USB-A Sensors
ZB2004, ZB2005, ZB2006, ZB2007 & ZB2016

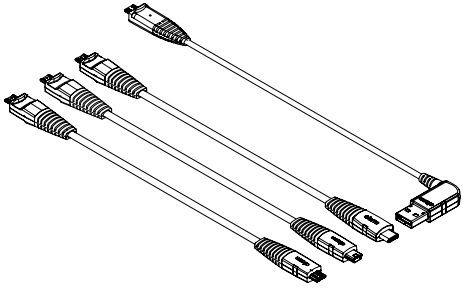

Note: Powered sensors require powered alarm units for proper functionality. Please see the Single or 4-Port Instructions for more information.

1 Plug the sensor into the corresponding port on the merchandise to be displayed.

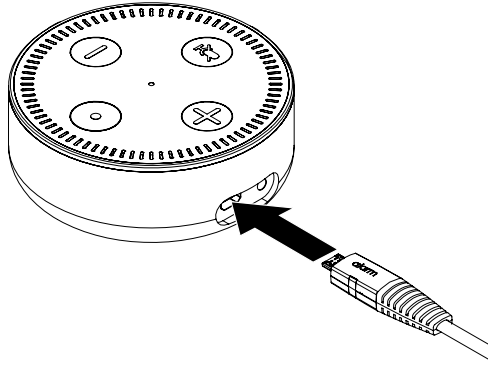

2a **If installing the Laptop Sensor (ZB2016):**

Use the provided alcohol wipe to clean the area on the laptop above where the sensor is plugged in. Allow it to dry completely.

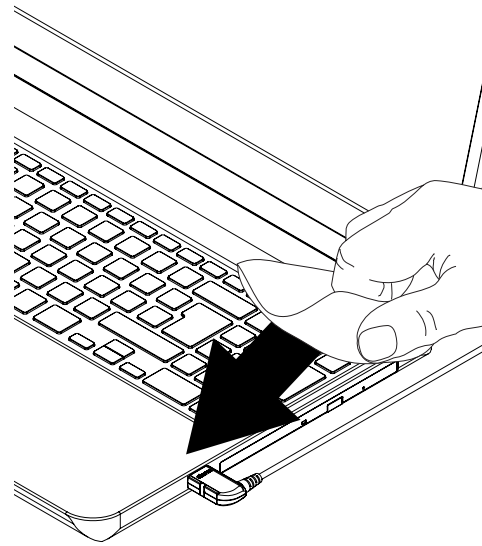

2b Peel the clear film from the adhesive on the bracket.

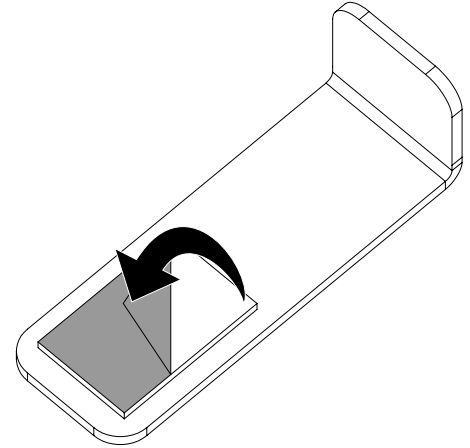

2c Place the bracket onto the laptop over the sensor. Apply pressure for at least 10 seconds.

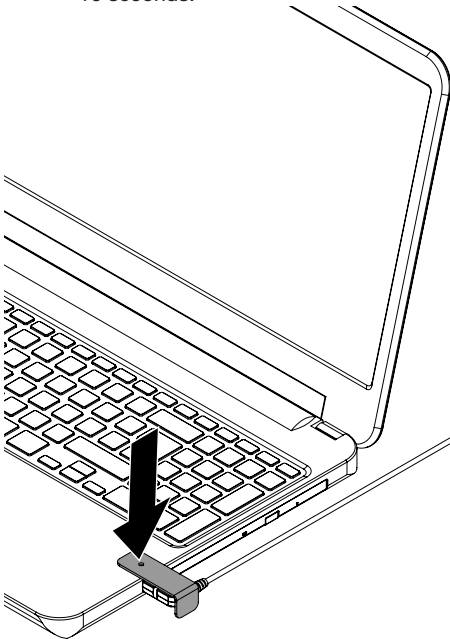

3 Plug the sensor into the previously installed alarm unit.

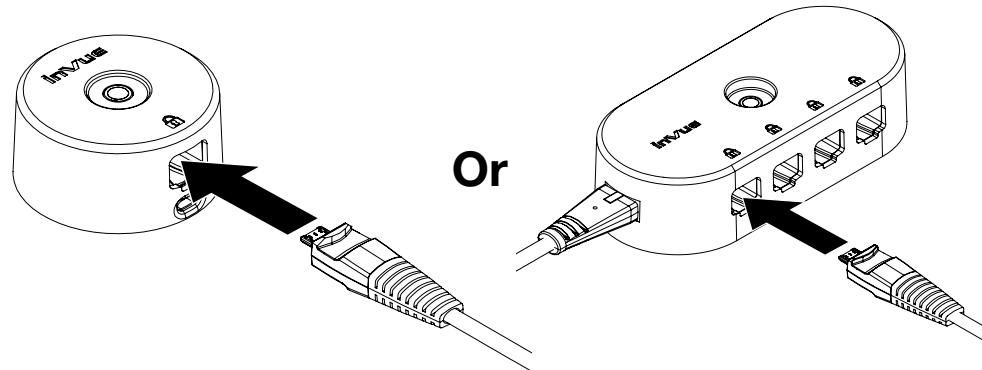

Note: Powered sensors are also compatible with S2865 Power/Alarm boxes & Zips Power Multiport. Non-Powered sensors are also compatible with S2865 Power/Alarm boxes, OnePOD & S960 aux ports, Zips Power Multiport & Zips 2.0.

- 4 To remove the sensor from the alarm unit; use a charged and coded key to deactivate the unit, then place the magnet key onto the lock icon on alarm unit above the sensor. Push in slightly and unplug the sensor.

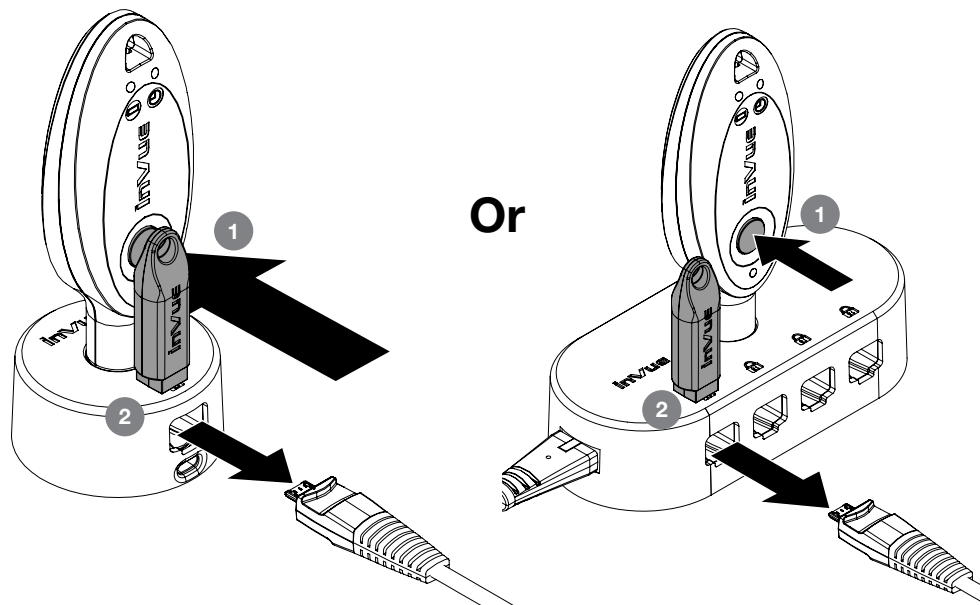

SD0641 Rev1 03/06/19



SABEL

1300 551 662
info@sabel.com.au